

Dolphin CT40 Computer – Configuration Guide

- Included in the box:
- CT40 Mobile Computer
 - Battery
 - Hand strap

(Stylus is not included, but available to order separately as an accessory)

N6603



N3601



CT40 Android Nougat 7.1.1 – 4G WWAN – N6603 Slim – 4GB RAM/ 32GB Flash

CT40-L1N-2SC110E

CT40, Android 7.1.1, WWAN, 802.11 a/b/g/n/ac/r/k/mc, 1D/2D Imager SR(N6603) Slim, 4GB/32GB Memory, 13MP Camera, BT 5.0, NFC, Battery 4,090 mAh World Wide Mode

CT40 Android Nougat 7.1.1 – 4G WWAN – N3601 – 2GB RAM/ 32GB Flash

CT40-L1N-1NC110E

CT40, Android 7.1.1, WWAN, 802.11 a/b/g/n/ac/r/k/mc, 1D/2D Imager SR(N3601), 2GB/32GB Memory, 13MP Camera, BT 5.0, NFC, Battery 4,090 mAh World Wide Mode

CT40 Android Nougat 7.1.1 – WiFi Only – N6603 Slim – 4GB RAM/ 32GB Flash

CT40-L0N-2SC110E

CT40, Android 7.1.1, WLAN, 802.11 a/b/g/n/ac/r/k/mc, 1D/2D Imager SR(N6603) Slim, 4GB/32GB Memory, 13MP Camera, BT 5.0, NFC, Battery 4,090 mAh World Wide Mode

CT40 Android Nougat 7.1.1 – WiFi Only – N3601 – 2GB RAM/ 32GB Flash

CT40-L0N-1NC110E



CT40, Android 7.1.1, WLAN, 802.11 a/b/g/n/ac/r/k/mc, 1D/2D Imager SR(N3601), 2GB/32GB Memory, 13MP Camera, BT 5.0, NFC, Battery 4,090 mAh World Wide Mode

Honeywell Repair Services

SVCCT40-5FC3

CT40, PLUS, 5 Day Turnaround, 3 Year, Day One

Dolphin CT40 Configuration Map

| | Bluetooth/ WiFi | WWAN | NFC | — | Memory | Imager | Camera | Operating System | Battery | Options | Domain | Description | Notes |
|-------|-----------------|------|-----|---|--------|--------|--------|------------------|---------|---------|--------|--|---|
| CT40- | | | | | | | | | | | | | |
| | L | | | | | | | | | | | 802.11 a/b/g/n/ac/r/k/mc + Bluetooth 5.0 | IEEE 802.11 a/b/g/n/ac; Wi-Fi certified V5.0 Bluetooth and BLE Supported Bluetooth Profiles: HFP,PBAP, A2DP, AVRCP, OPP, SPP, GATT |
| | 1 | | | | | | | | | | | LTE (4G) GPS, UMTS/HSPA+ (3G) GSM/GPRS/EDGE | WWAN Radio (ATT/VZW/SPRINT/TMO/NA/EU) LTE (FDD) – Bands 1,2,3,4,5,7,8,12,13,17,19,20,25,26,28,29 LTE (TDD) – Bands 38,39,40,41 UMTS/HSPA+ (3G) – Bands 1, 2, 4, 5, 6, 8, 9, 19 GSM/GPRS/EDGE Quad-Band (850/900/1800/1900 MHz) |
| | 0 | | | | | | | | | | | No WWAN | |
| | | N | | | | | | | | | | Near Field Communication (NFC) | Integrated Near Field Communication |
| | | | — | | | | | | | | | | |
| | | | | | 1 | | | | | | | 2GB RAM/32GB Flash Memory | 2.2 GHz Qualcomm Snapdragon™ 660 octa-core |
| | | | | | 2 | | | | | | | 4GB RAM/32GB Flash Memory | 2.2 GHz Qualcomm Snapdragon™ 660 octa-core |
| | | | | | | N | | | | | | 1D/2D Imager (N3601) |  |
| | | | | | | S | | | | | | 1D/2D Imager (N6603) |  |
| | | | | | | | C | | | | | 13MP Camera | 13-megapixel color camera auto focus with flash (rear), 4K video with image stabilization, and advanced software features for enhanced exposure control |
| | | | | | | | | 1 | | | | Android Nougat 7.1.1 (GMS) | Google Mobile Services (GMS) certified – Play Store |
| | | | | | | | | | 1 | | | Standard Battery | Li-Ion, 3.8 V, 4090 mAh with integrated battery diagnostics |
| | | | | | | | | | | 0 | | No Option | |
| | | | | | | | | | | | E | ETSI | Austria, Belgium, Brazil, Bulgaria, Chile, Columbia, Croatia, Cyprus, Czech Republic, Denmark, Dominican Republic, Ecuador, El Salvador, Estonia, Finland, France, Germany, Greece, Hong Kong, Hungary, Iceland, Ireland, Italy, Japan, Latvia, Liechtenstein, Lithuania, Luxembourg, Malta, Netherlands, Norway, Peru, Philippines, Poland, Portugal, Romania, Singapore, Slovakia, Slovenia, South Korea, Spain, Sweden, Switzerland, Thailand, United Kingdom, Venezuela |

Honeywell Repair Services

CT40 – Repair Services

For Best-In-Class Service

With Honeywell Repair Services, it’s easy to get the level of repair coverage and protection that makes the most sense for your business. And our repair services are now available in over 70 countries with global pricing and global standards of quality.

Choose from one of our new cost-effective Repair Service contract programs – Complete, Plus or Basic – to get the right amount of coverage and protection you need for your durable, rugged and ultra-rugged products. And for equipment not covered by a contract service plan, you can choose from our Non-Contract Repair Service offerings, which include flat-rate repairs, time-and-materials repairs and more.

Ensure business continuity, workflow performance and protection of your technology investments with Honeywell Repair Services.

Plus Repair Services

Protect your technology investment! With Honeywell’s 3 and 5 year Plus comprehensive repair services plan, you won’t incur any additional costs beyond the plan enrollment for service on covered devices and eligible accessories included with equipment sent to the depot for service. Eligible accessories include damaged styluses, battery-door covers, screen protectors, hand straps and clips.

Service Overview

- Features and benefits include:
- Comprehensive coverage – including device replacement for rugged or stationary products
- Day One multi-year pricing for lower annualized costs
- Three years of locked-in service-price protection, with optional renewals
- Options for 2-day and 5-day service levels
- Cleaning and preventive maintenance
- Telephone-based technical support
- Convenient online Return Authorization requests and access to online service-history reports

| Part Number | Description |
|------------------|---|
| SVCCT40-5FC3 | CT40, PLUS, 5 Day Turnaround, 3 Year Day One |
| SVCCT40WWAN-5FC3 | CT40, PLUS, WWAN ONLY 5 Day Turnaround, 3 Year, Day One |
| SVCCT40-2FC3 | CT40, PLUS, 2 Day Turnaround, 3 Year, Day One |
| SVCCT40WWAN-2FC3 | CT40, PLUS, WWAN ONLY 2 Day Turnaround, 3 Year, Day One |

Complete Repair Services

The only contract you will ever need! With Honeywell’s 3 and 5 year Complete comprehensive repair services plan, one contract covers it all – device, power management and accessories. Eligible accessories and power management for mobile computers include: batteries, docks, chargers, cradles, cables, damaged styluses, battery-door covers, screen protectors, hand straps and clips.

Service Overview

- Features and benefits include:
- Comprehensive coverage – including device replacement for rugged or stationary products
- Coverage for power management and select accessories
- Day One multi-year pricing for lower annualized costs
- Five years of locked-in service-price protection
- Options for overnight and 2-day or 5-day service levels
- Cleaning and preventive maintenance
- Telephone-based technical support
- Convenient online Return Authorization requests and access to online service-history reports

| Part Number | Description |
|--------------|---|
| SVCCT40-5PS3 | CT40, COMPLETE, 5 Day Turnaround, 3 Year, Day One Includes Power Management Protection, Browser Maintenance, Battery Refresh (APAC Only) |
| SVCCT40-2PS5 | CT40, COMPLETE, 2 Day Turnaround, 5 Year, Day One Includes Power Management Protection, Browser Maintenance, Battery Refresh |

Honeywell Repair Services

CT40 – Repair Services

For Best-In-Class Service



CT40 WiFi Only Devices

| Part Number | Description |
|--------------|--|
| SVCCT40-EXW3 | CT40, BASIC, 10-15 Day Turnaround, 2 Years (1 Year Factory Warranty + 2 Year Extended) |
| SVCCT40-5RC3 | CT40, RETAIL, 5 Day Depot, Comprehensive Repairs are included but does not include Device Replacement, 3 Year. WWAN enabled devices are not eligible for this service. |
| SVCCT40-5FC3 | CT40, PLUS, 5 Day Turnaround, 3 Year, Day One |
| SVCCT40-5PS3 | CT40, COMPLETE, 5 Day Turnaround, 3 Year Day One, Includes Power Management Protection, Accessory Coverage and Software Maintenance for Client Pack. |

CT40 4G WWAN Devices

| Part Number | Description |
|------------------|---|
| SVCCT40WWAN-EXW3 | CT40, BASIC, WWAN ONLY 10-15 Day Turnaround, 2 Years (1 Year Factory Warranty + 2 Year Extended) |
| SVCCT40WWAN-5FC3 | CT40, PLUS, WWAN ONLY 5 Day Turnaround, 3 Year, Day One |
| SVCCT40-5PS3 | CT40, COMPLETE, 5 Day Turnaround, 3 Year Day One, Includes Power Management Protection, Accessory Coverage and Software Maintenance for Client Pack |

Honeywell Repair Services

CT40 – Repair Services

For Best-In-Class Service

Advanced Exchange Service:
Your Equipment "On Demand"

For overnight replacement of your Honeywell device, upgrade to our Advanced Exchange Service.

- Customer-owned, Honeywell-managed inventory ready for overnight shipment when you need it.
- Ship the damaged device to us; we'll repair it and add it to your Honeywell managed inventory to replace the device we shipped.

| Part Number | Description |
|---------------|--|
| SVCCT40-AEFC3 | CT40, PLUS, Advanced Exchange, 3 Year, Day 1 |
| SVCCT40-AERC3 | CT40, RETAIL, Advance Exchange, Comprehensive Repairs are included but does not include Device Replacement, 3 year |

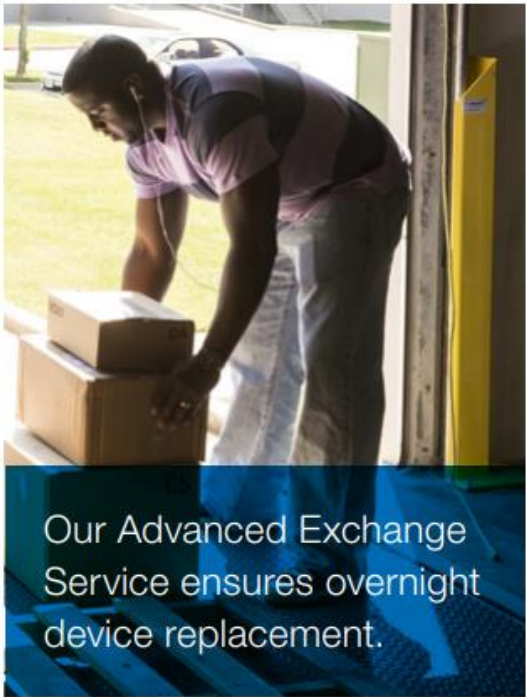

Golden Image

Need the Honeywell Repair Centre to load your software after repair, the Golden Image can be loaded to fast track your devices.

- This is an additional offering which can be added to your Plus and Complete Service.
- Please contact your local Honeywell Representative for more information on this service.

| Part Number | Description |
|---------------|---|
| SVCMOB-IMAGE3 | Golden Image Service - load of customer image on units in repair, Adder to Comprehensive Service, 3 Year Term, 100 unit minimum, Contact Services Sales Manager for Pricing |

| | |
|---------------|---|
| SVCMOB-IMAGE5 | Golden Image Service - load of customer image on units in repair, Adder to Comprehensive Service, 5 Year Term, 100 unit minimum, Contact Services Sales Manager for Pricing |
|---------------|---|

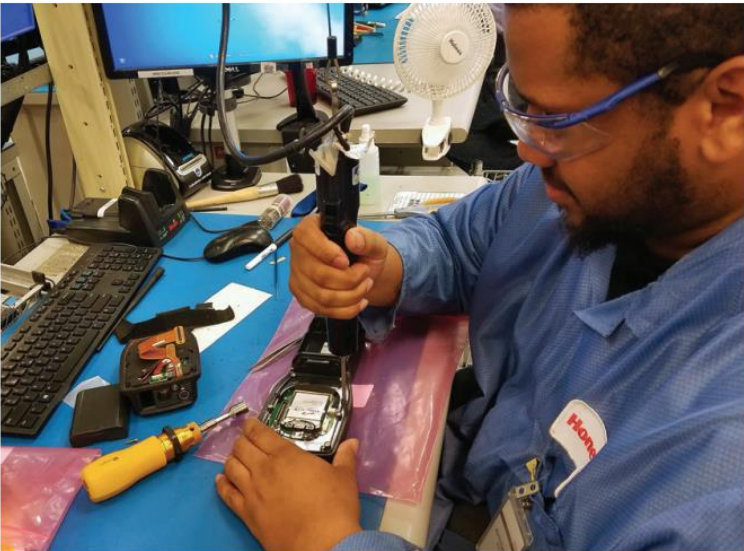

Dolphin CT40 Scanning

Option 1 – Scan Handle

Use for Scan intensive applications



CT40 with Scan Handle Installed on Home Base

| | Part Number | Description |
|---|-------------|--|
| 1 | CT40-SH-DC | CT40 Scan Handle Compatible for use with Home Base and Charge Base without removal. |

Dolphin CT40 Desktop Communications

Option 1 – Portable

USB Communication OR Snap-On Charging



| | Part Number | Description |
|---|---------------|--|
| 1 | CT40-SN-USB-0 | Snap-on cup with Standard Type A connector. |
| 2 | 50136024-001 | KIT,5V/2A PS,5 PLUGS PACKED, ROW Includes US,UK,AU,EU,IN adapters |

Option 2 – Fixed

USB and optional Ethernet Communication & Single Battery Charger



| | Part Number | Description |
|----|-------------|---|
| 1 | CT40-HB-3 | HomeBase – UK Kit includes Dock, Power Supply and UK Power Cord |
| OR | CT40-EB-3 | eHomeBase – UK Ethernet Kit includes Dock, Power Supply and UK Power Cord |
| 2 | 321-576-004 | Cable Assembly - USB Type A to Type B |

Dolphin CT40 Desktop Communications

Option 3 – Display Base

Connect USB peripherals (keyboard, mouse) and External Monitor via HDMI



Ethernet USB A HDMI POWER
Rear View



2 x USB Type A on the side
Side View

| Part Number | Description |
|-------------|---|
| 1 CT40-DB-3 | For connection with an external display, and extends I/O for HDMI, Ethernet communications and 3 USB ports. UK Kit includes Display Base, Power Supply and UK Power Cord |

Dolphin CT40 Vehicle Install

Option 1 – Portable/ Sub Contractor Install

Simple Vehicle Charging, portable between vehicles



| Part Number | Description |
|-------------|--|
| 1 | CT40-SN-VPA Snap On Adaptor with USB Port and Auto Adapter Kit includes CT40-SN-USB-0and ACGMTRACKCWU1 (Provides 12 V/24 V cigarette lighter port to USB type-A power adapter for snap-on use in a vehicle) |

Option 2 – Portable/ Sub Contractor Install

Windscreen Suction Cup Mount, portable between vehicles.



| Part Number | Description |
|-------------|---|
| 1 | CT40-VD-0 Vehicle Dock w/ hard wired 3-pin power cable |
| 2 | RAM-B-166-202U Suction Cup Mount Kit |
| 3 | 50138169-001 Cigarette Lighter Power Adapter Cable |

Dolphin CT40 Vehicle Install

Option 3 – Fixed Vehicle Install with Direct Connection to Vehicle Battery/ Fuse Block

Best used when the vehicle input voltage varies, 12- 24V.



| | Part Number | Description |
|----|-------------|---|
| 1 | CT40-VD-0 | Vehicle Dock w/ hard wired 3-pin power cable |
| 2 | 226-109-003 | 72" (182.88 cm) Fuse block Power Cable with spade lugs and 3-pin connector |
| OR | 226-109-004 | 22" (55.8 cm) Fuse block Power Cable with spade lugs and 3-pin connector |
| 3 | 805-611-001 | Mounting Kit, V-Dock RoHS |
| | 203-803-001 | Vehicle Dock Fuse Block Power Kit RoHS (Provides connection to vehicle fuse block). Requires Power Cable (226-109-003 or 226-109-004). |

Dolphin CT40 Vehicle Install

Option 4 – Fixed Vehicle Install with DC/DC Converter

Best used when the vehicle input voltage varies, 6-60V or 15-96V.



| | Part Number | Description |
|----|-------------|---|
| 1 | CT40-VD-0 | Vehicle Dock w/ hard wired 3-pin power cable. |
| 2 | 203-808-001 | DC/DC Converter Kit, <u>6-60V</u> DC, RoHS |
| OR | 203-809-001 | DC/DC Converter Kit, <u>15-96V</u> DC RoHS |
| 3 | 805-611-001 | Mounting Kit, V-Dock RoHS |

Dolphin CT40 Vehicle Install

Option 5 – Fixed Vehicle Install with Thor DC/DC Converter

Best used when the vehicle input voltage varies, 9-60V or 50-150V.



| | Part Number | Description | |
|----|-------------|-----------------|---|
| OR | 1 | CT40-VD-0 | Vehicle Dock w/ hard wired 3-pin power cable |
| | 2 | 9000311PWRSPPLY | DC/DC Converter Kit, <u>9-60V</u> DC, RoHS (Requires 226-109-003 Wiring Harness) |
| | | 9000313PWRSPPLY | DC/DC Converter Kit, <u>50-150V</u> DC RoHS (Requires 226-109-003 Wiring Harness) |
| | | 226-109-003 | 72" (182.88 cm) Fuse block Power Cable with spade lugs and 3-pin connector |
| | 3 | 805-611-001 | Mounting Kit, V-Dock RoHS |

Dolphin CT40 Vehicle Install

CT40 Vehicle Dock 360 degree view



Front View



Rear View



Side View



Rear Profile

Side Profile

Dolphin CT40 Charging and Communications

Option 1 – CT40 Quad Charger

Chargebase – Quad Dock Charge Only
Netbase – Quad Dock with Ethernet



| Part Number | Description |
|------------------|---|
| 1 CT40-CB-CNV-3 | Chargebase - UK Kit includes Dock, Power Supply and UK Power Cord |
| OR CT40-NB-CNV-3 | Netbase - UK Kit includes Dock, Power Supply and UK Power Cord |

Option 2 – Battery Charger

Charge up to 4 batteries simultaneously

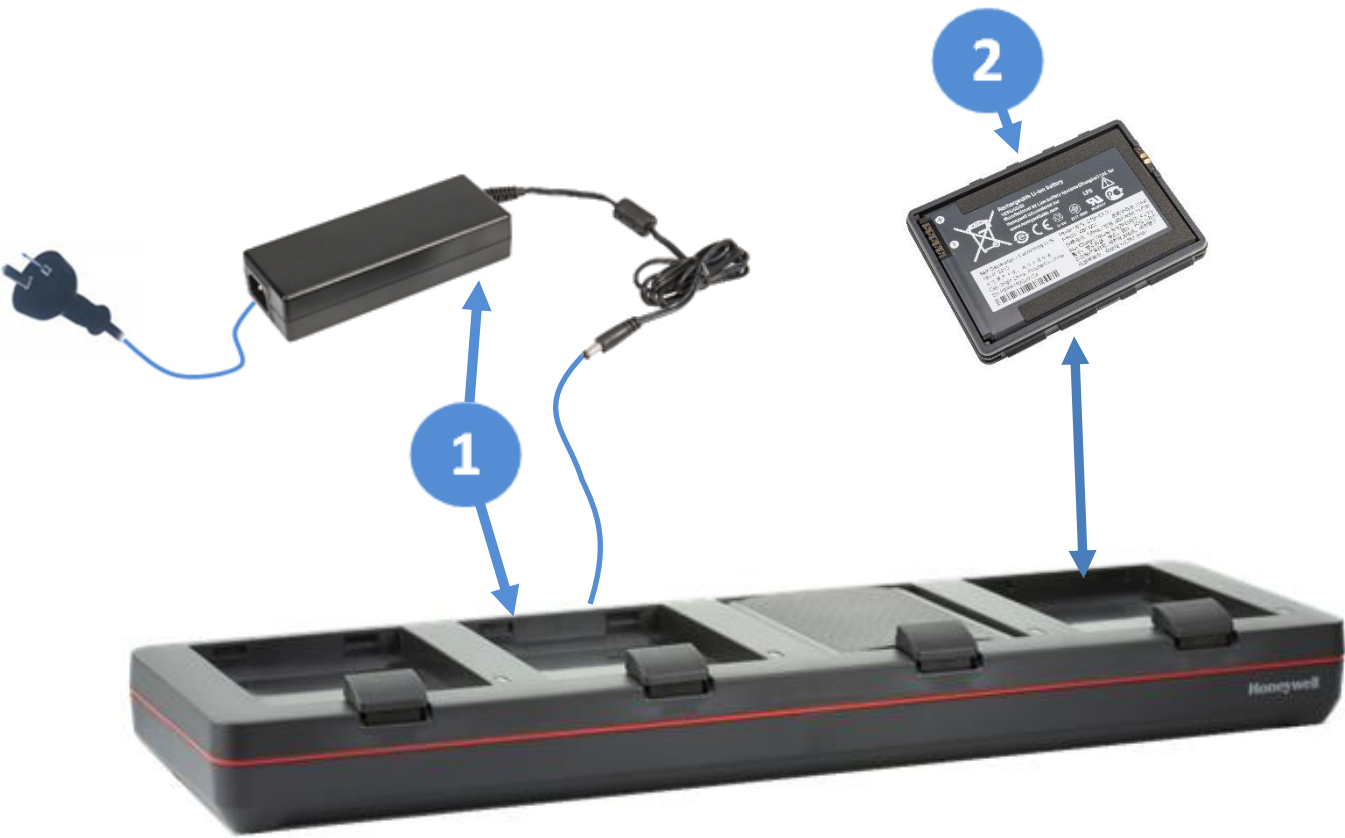

| Part Number | Description |
|---------------|---|
| 1 CT40-QBC-3 | Quad Battery Charger – UK Kit includes Dock, Power Supply and UK Power Cord |
| 2 318-055-010 | Replacement Battery for CT40, 4,090mAh |

Dolphin CT40 Accessories

Rubber Boot

Use for added protection of the CT40



Front View



No Hand strap



Rear View - Hand strap Installed

| | Part Number | Description |
|---|-------------|--|
| 1 | CT40-RB-00 | CT40 Rubber Boot Not Compatible with CT40-SH-DC Scan Handle or Home Base / Charge Base Docks / Vehicle Dock |

Miscellaneous

CT40 Accessories



| Part Number | Description |
|-------------|----------------------------|
| CT40-HS-3PK | CT40 Hand strap, pack of 3 |



| Part Number | Description |
|--------------|---|
| CT40-SP-10PK | Contains 10 self-adhesive screen protectors |



| Part Number | Description |
|--------------|--|
| 50121666-001 | Power Adapter, 12V 3A, No Power Cord, Compatible with CT40 Homebase / eHomebase / Quad Battery Charger |



| Part Number | Description |
|-------------|--|
| 213-048-001 | Pack of 5 CT40/CT50/CT60 replacement styluses. |



| Part Number | Description |
|----------------|---|
| 8754-871600-20 | Pack of 10 CT40/CT50/CT60 replacement Styluses. |



| Part Number | Description |
|--------------|--|
| 50121667-001 | Power Adapter, 12V 7A, No Power Cord 4-Bay Charge Base Power Supply CT40 Quad Chargebase/ Quad Netbase |

Miscellaneous

CT40 Accessories



| Part Number | Description |
|-------------|---|
| CT50-CC-12 | CHARGING CABINET FOR CT40/CT50/CT60 with space to house 12 Computers and 12 Spare Batteries. Quad battery chargers (CT40-QBC-3) and Quad ChargeBase (CT40-CB-3) or NetBase (CT40-NB-3) must be ordered separately. |



| Part Number | Description |
|-------------|-----------------------|
| 825-237-001 | POUCH, CT40/CT50/CT60 |

| Part Number | Description |
|-------------|-------------------------|
| 825-238-001 | CT40/ CT50/CT60 Holster |

Miscellaneous

Honeywell Recommended – ATP Industrial Grade Micro SD Cards

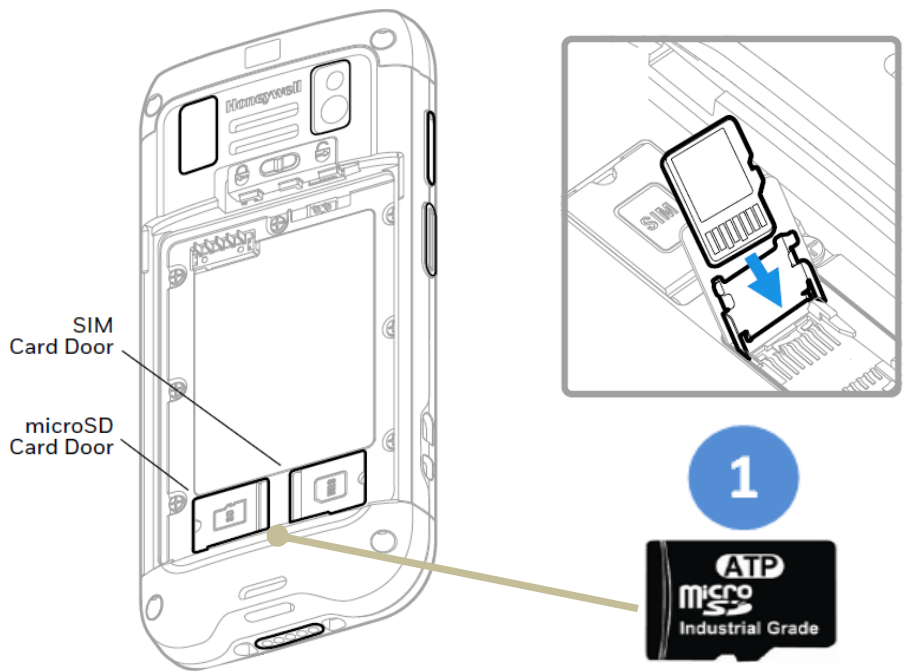

| | Part Number | Description |
|----|-------------|---|
| 1 | 856-065-004 | MICRO-SD CARD, <u>1GB</u> , AF1GUDI, ROHS |
| OR | 856-065-005 | MICRO-SD CARD, <u>2GB</u> , AF2GUDI, ROHS |
| OR | 856-065-006 | MICRO-SD CARD, <u>4GB</u> , AF4GUDI, ROHS |
| OR | 856-065-007 | MICRO-SD CARD, <u>8GB</u> , AF8GUDI, RoHS |

Why ATP Industrial Grade SD?

ATP's SIP (System-In-Packaging) manufacturing process encapsulates all exposed components and points of failure to ensure the products are fully waterproof, shockproof, and ESD (Electro-Static Discharge) proof. ATP Industrial GradeSD/SDHC Cards can withstand at least an operating/storage temperature range of at least -40 to 85 degrees Celsius. In addition to this temperature range, the cards are completely waterproof, dustproof, and ESD (Electro-Static Discharge) proof. All ATP Industrial Grade SD/SDHC cards are produced under a stringent RoHs and Green Package compliant manufacturing process to guarantee a consistent high level of build quality and performance. ATP Industrial SD cards deliver outstanding performance with read speed (seq) up to 18MB/sec and write speed (seq) up to 16MB/sec. All ATP Industrial Grade CF, SD, USB drives, and SSDs are constructed using best-in-class SLC(Single-Level Cell) components with enhanced Error Correction Code(ECC) functions and wear levelling algorithms. This results in MTBF ratings over 2 million hours and the highest write cycle lifetimes in the industry.

AC Cords

| Part Number | Description |
|--------------|-------------------------------|
| 50117501-001 | AC Power Cord, Australia |
| 19-19807 | AC Power Cord, China |
| 9000091CABLE | AC Power Cord, Denmark |
| 77900508E | AC Power Cord, Europe |
| 50127245-001 | AC Power Cord, India |
| 9000092CABLE | AC Power Cord, Italy |
| 321-500-002 | AC Power Cord, Japan |
| 9000093CABLE | AC Power Cord, Switzerland |
| 77900507E | AC Power Cord, United Kingdom |
| 19-19726 | AC Power Cord, United States |

Disclaimer

Honeywell International Inc. (“HII”) reserves the right to make changes in specification and other information contained in this document without prior notice, and the reader should in all cases consult HII to determine whether any such changes have been made. The information in this publication does not represent a commitment on the part of HII.

HII shall not be liable for technical or editorial errors or omissions contained herein; nor for incidental or consequential damages resulting the furnishing, performance, or use of this material.

This document contains proprietary information that is protected by copyright. All rights are reserved. No part of this document may be photocopied, reproduced, or translated into another language with-out prior written consent of HII.

Web Address: www.honeywellaidc.com

The Bluetooth trademarks are owned by Bluetooth SIG, Inc., U.S.A and licensed to Honeywell.

Other product names mentioned in the manual may be trademarks of registered trademarks of their respective companies and are the property of their respective owners.

© 2018 Honeywell International Inc. All rights reserved.