

Contents of the box:

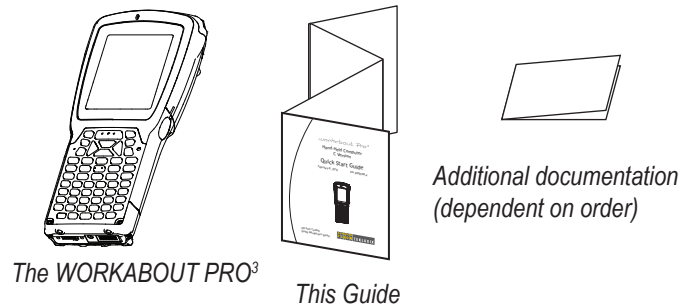

Features: Front

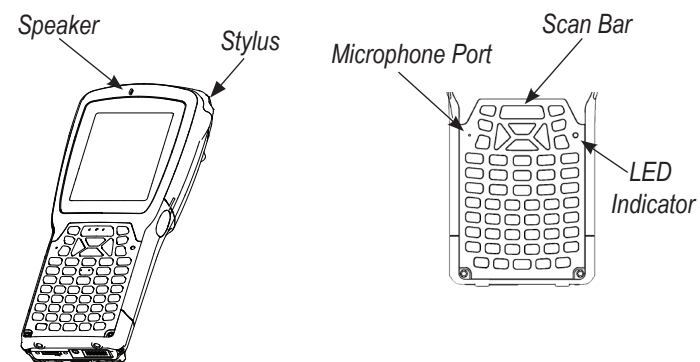

Features: Back and Ports

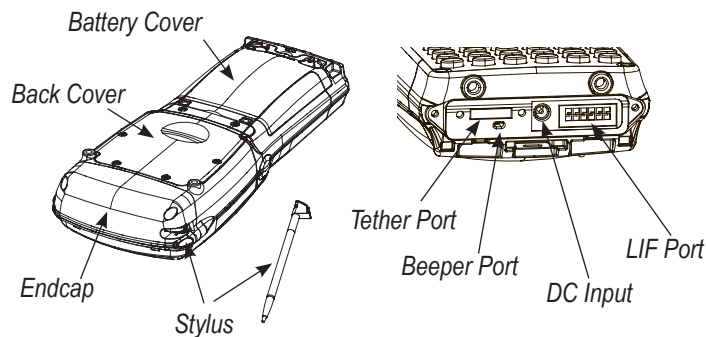

Features: Typical Variants

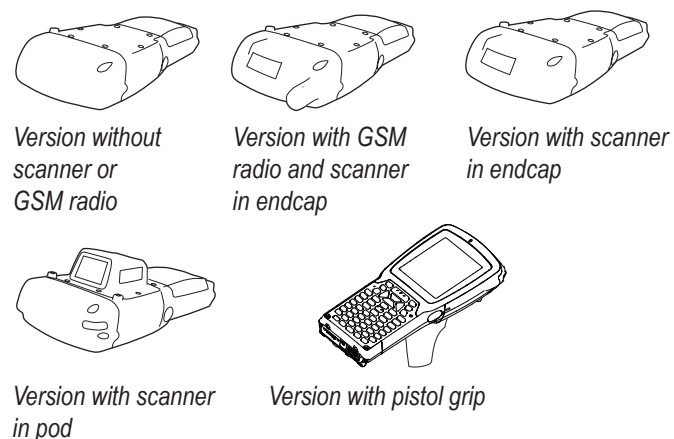

Features: The Battery Compartment

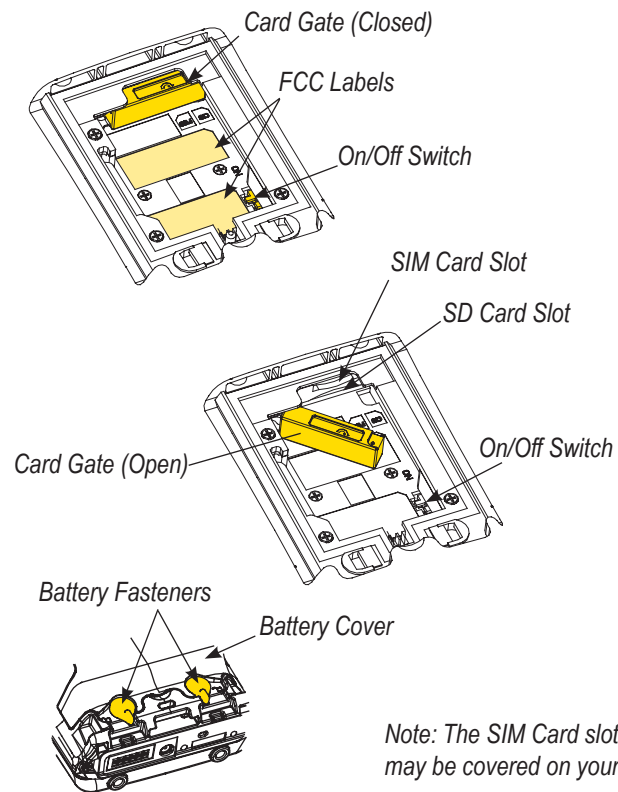

Getting Started

- 1** Switch the hardware on.

On/Off Switch ON
 - 2** Insert the battery.
 - 3** Close and lock the battery cover.

Battery Fasteners

Turn the fasteners towards the centre of the unit to lock the battery cover.
- Over

- 4 Charge the battery.** The power adaptor may be plugged directly into the WORKABOUT PRO³.

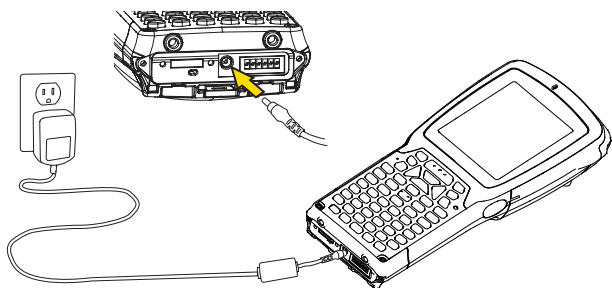

The WORKABOUT PRO³ may also be charged in a Docking Station.

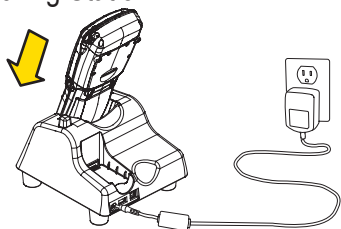

Note: Use only the universal AC power adaptor approved by Psion Teklogix for the WORKABOUT PRO³.

Allow the WORKABOUT PRO³ to charge for 6 hours.

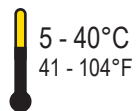

Note: Full battery performance is only reached after the first few full charge/discharge cycles.

- 5 Turn the unit on.** Press the Power button for a few seconds.

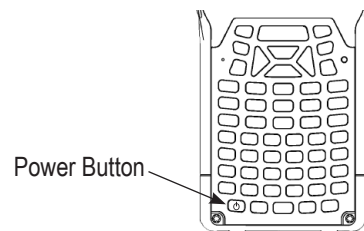

- 6 Connect the WORKABOUT PRO³ to the host computer.** Connect using a Tether Port to USB cable, or through a Docking Station.

- 7 Install ActiveSync®.**

Go to <http://go.microsoft.com/fwlink/?LinkId=147001> and follow the instructions to download and install ActiveSync 4.5 or higher.

Note: ActiveSync is not needed when connecting to a host computer that uses the Windows® Mobile Device Center (such as Microsoft® Windows Vista®).

- 8 Configure ActiveSync.** Follow the onscreen instructions provided by ActiveSync to establish a connection between the host computer and the WORKABOUT PRO³.

To turn the WORKABOUT PRO³ off, do one of the following:

- Press the **Power** button, or
- Select **Shut down** from the **Start** menu.

Resetting the unit

Important: Resetting may result in data loss.

To perform a cold reset:

- Press the **SCAN** bar, the **FN/BLUE** key, and the **ENTER** key simultaneously for a few seconds. During a cold reset, running programs are halted and RAM memory is cleared. The contents of flash memory and the registry are preserved. The operating system is reloaded.

To perform a warm reset:

- Press the **FN/BLUE** key and the **ENTER** key simultaneously for a few seconds. During a warm reset, running programs are halted. The contents of RAM, flash memory and the registry are preserved.



8000198

Rev. A

workabout Pro³

Hand-Held Computer
C Version

Quick Start Guide

February 8, 2010

PN 8000198.A

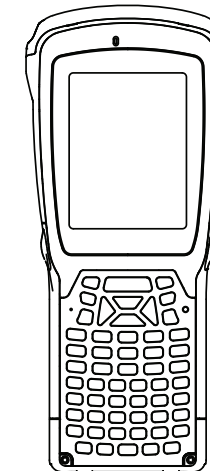

ISO 9001 Certified
Quality Management System

