

MC9190-G

Quick Start Guide

BATTERY INSERTION

<http://www.zebra.com/mc9190g>

See User Guide for more information

POST IN WORK AREA

Front View

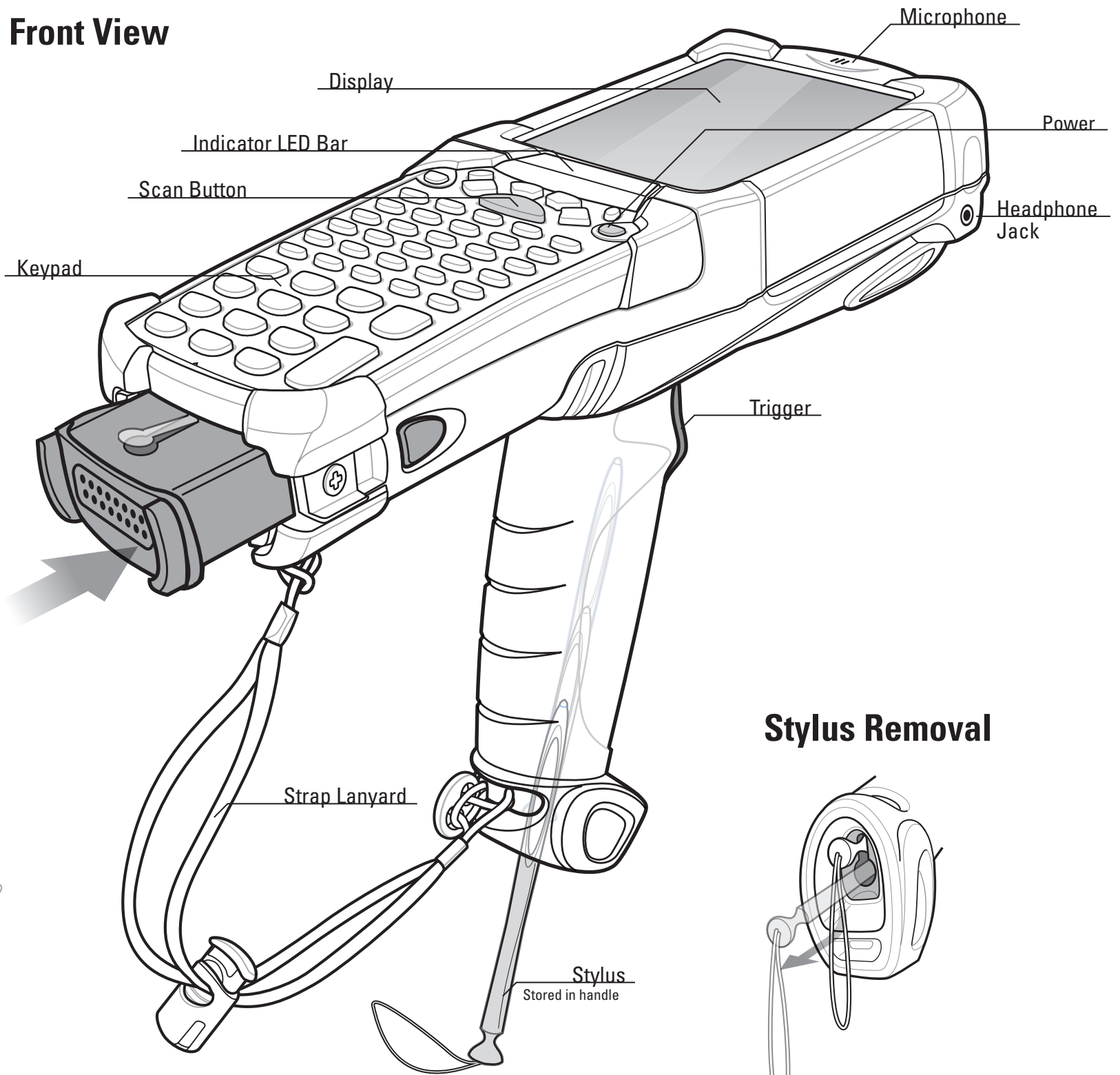

Battery Removal

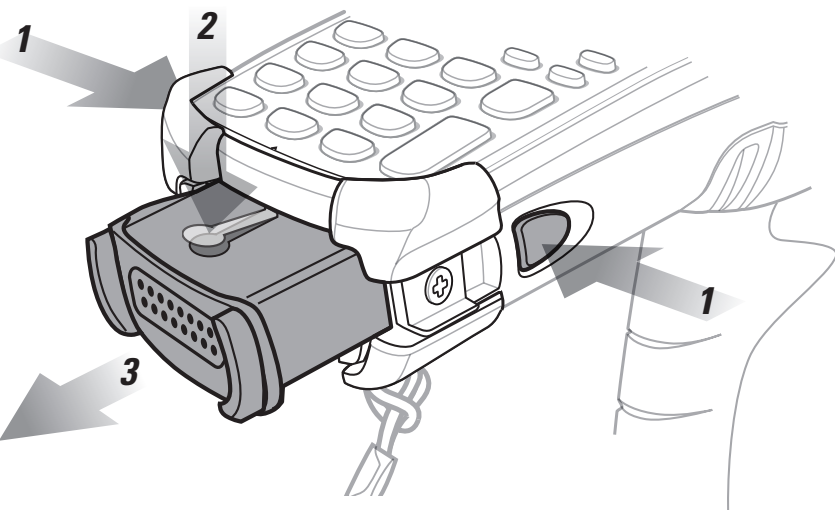

Stylus Removal

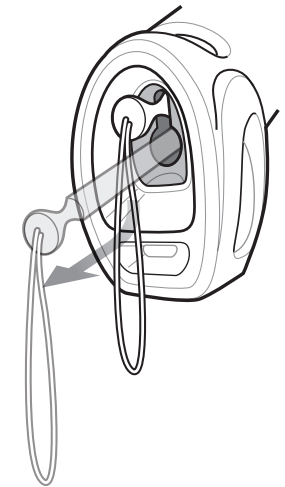

SNAP-ON ACCESSORY INSTALLATION

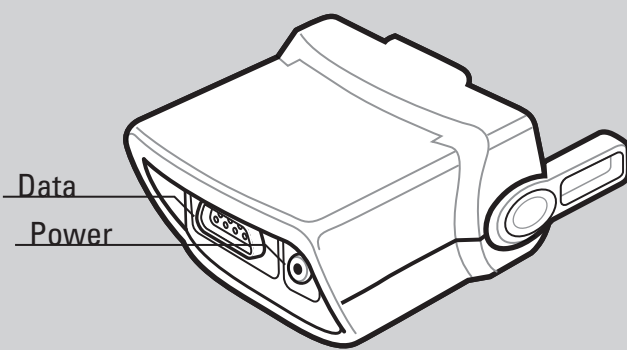
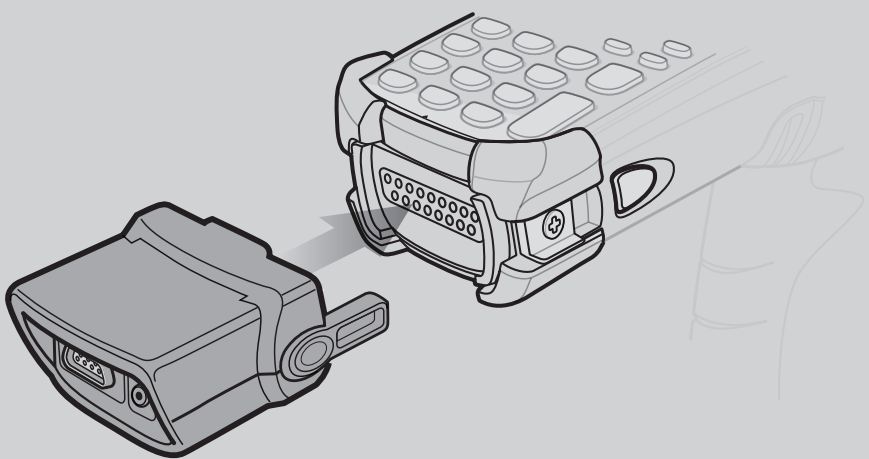

Cable Adapter Module

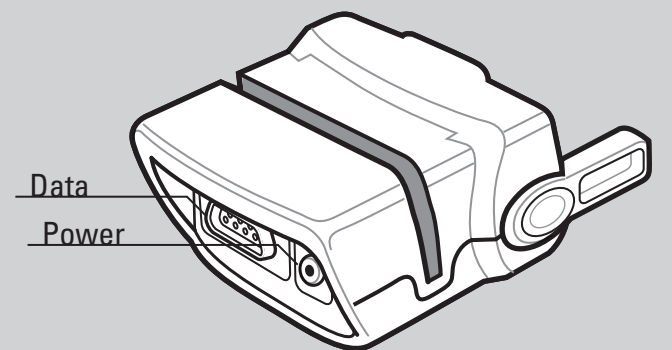

Data
Power

Magnetic Stripe Reader

CHARGING INSTRUCTIONS

⦿ = LED Indicator Location Slow Flash = Normal Charge Solid Amber = Full Charge Fast Flash = Charging Error

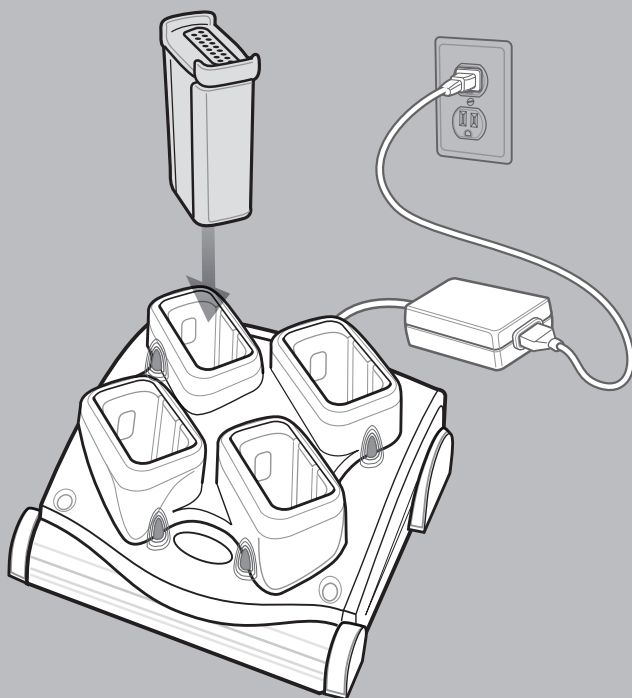

Four Slot Spare Battery Charger

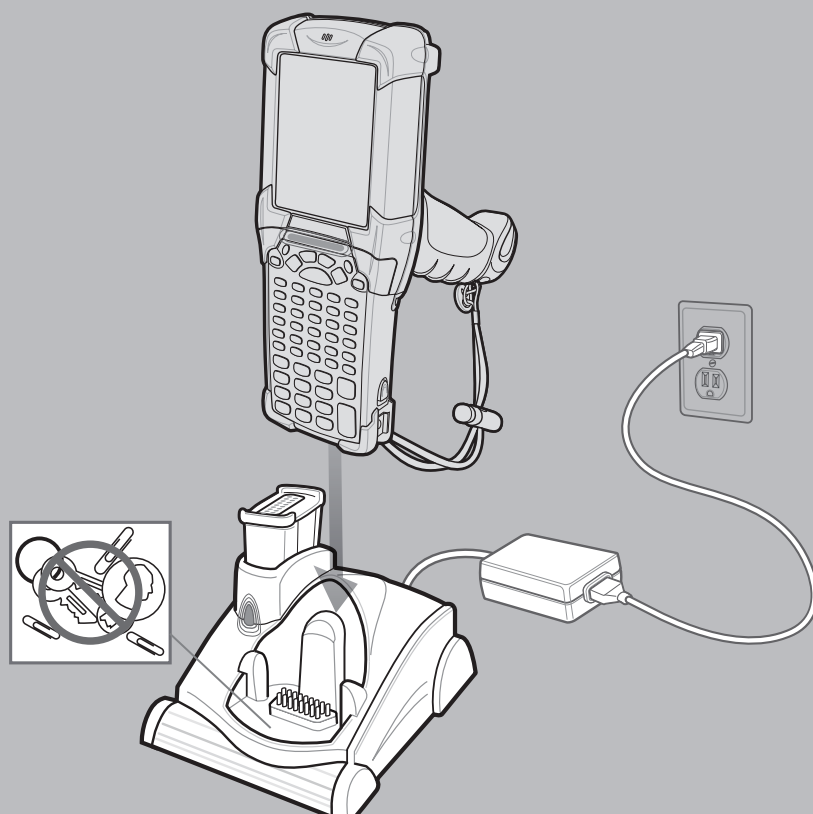

Single Slot Serial/USB Cradle

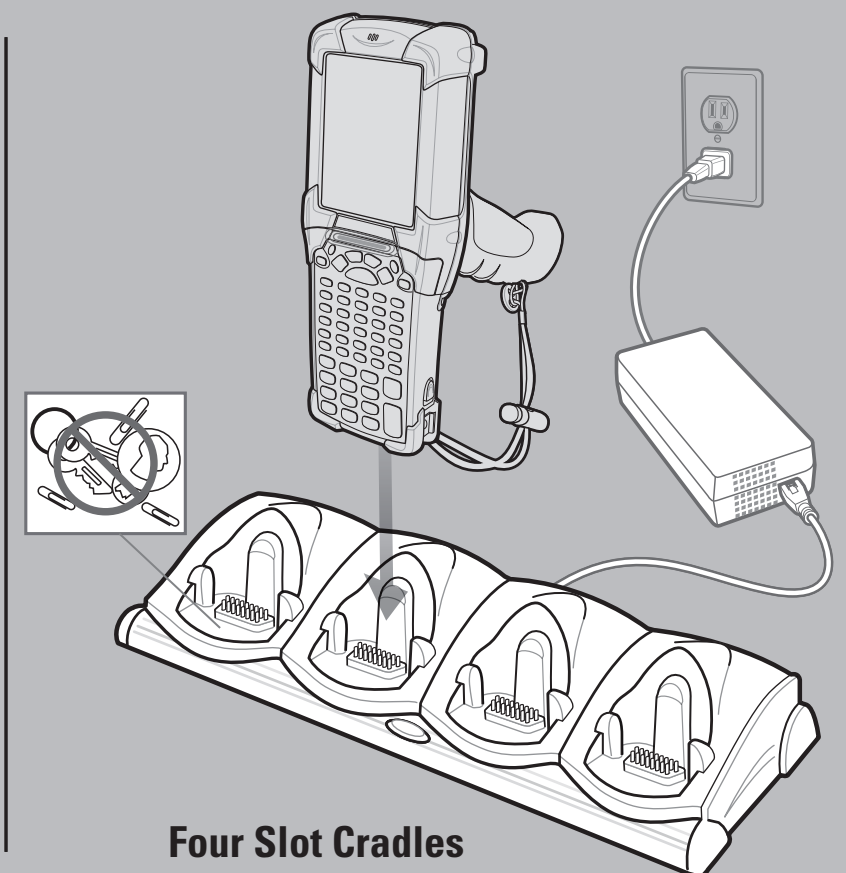

Four Slot Cradles

Charge-Only Cradle and Ethernet Cradle

OPTIMUM IMAGING AND SCANNING POSITIONS

Laser Scanning

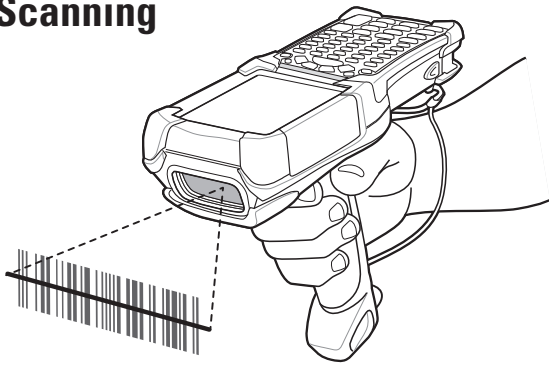

Standard Range Imaging

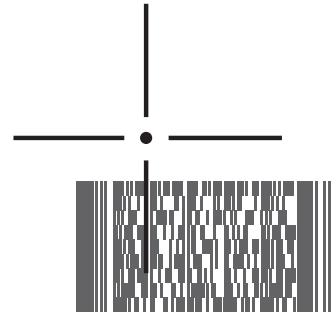
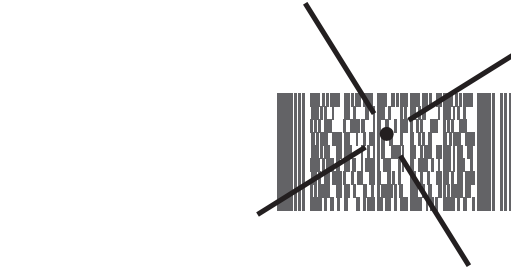
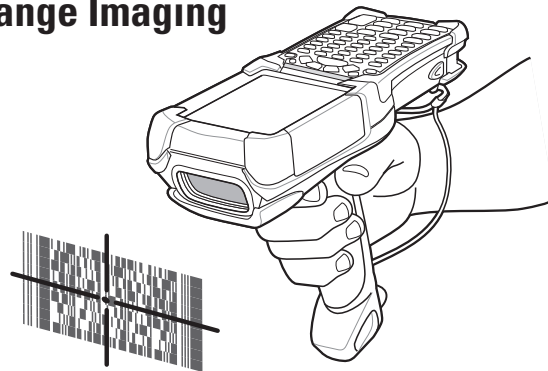

Long Range Imaging

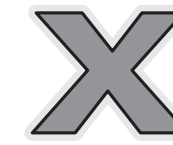
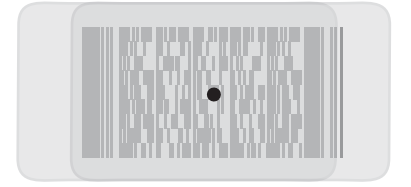
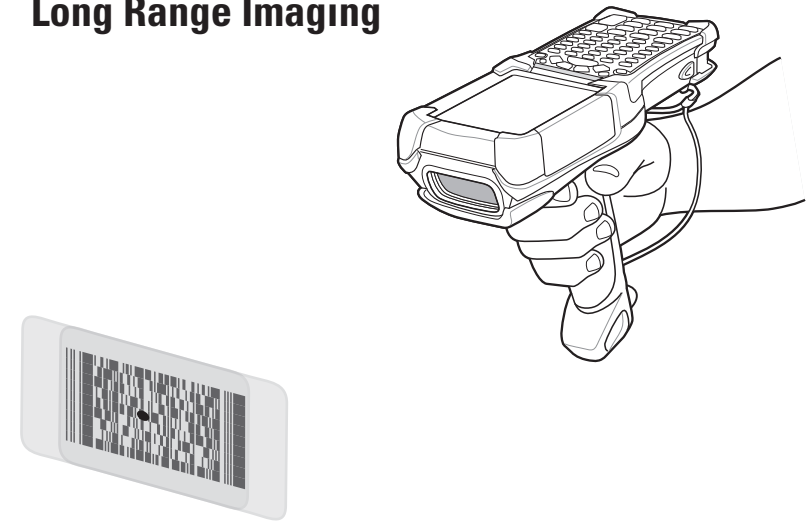

OPTIMUM UPRIGHT BODY POSTURE



AVOID EXTREME WRIST ANGLES

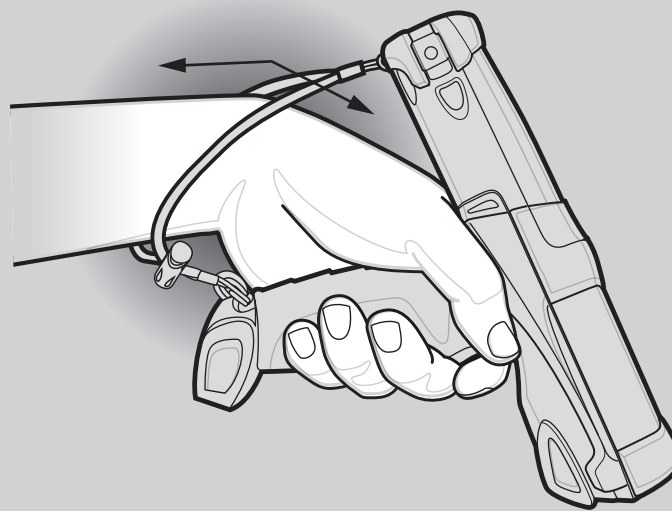

ALTERNATE LEFT AND RIGHT HANDS
TAKING BREAKS AND TASK ROTATION RECOMMENDED



AVOID EXTREME
WRIST ANGLES



OPTIMUM BODY POSTURE

Low Scanning

Alternate left and right knees



AVOID BENDING

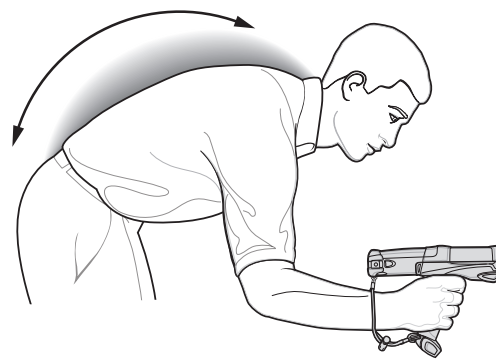

Alternate left and right hands



AVOID REACHING



High Scanning

Use a ladder



Taking breaks and
task rotation recommended



Zebra Technologies Corporation, Lincolnshire, IL USA
Zebra and the Zebra head graphic are registered trademarks of ZIH Corp. The Symbol logo is a registered trademark of Symbol Technologies, Inc., a Zebra Technologies company.
© 2015 Symbol Technologies, Inc.



72-139206-02 Rev. B - April 2015



<http://www.zebra.com/mc9190g>